

TO: Kane County Development Committee
Kane County Zoning Board
Kane County Government Center
719 Batavia Ave
Geneva, IL 60134

Regards to: Petition No. 4661

From: The concerned residents surrounding parcel ID# 06-08-401-013.

This is a written petition that I, Jacqueline Thompson and my husband Brandon Thompson, the residents at 12N271 Jackson Dr. Elgin, IL 60124 has put together with the help of all the other residents who are immensely opposed to the planned commercial solar energy facility, to be put up in our neighborhood. It is extremely unsettling that this would even be allowed to be put in a residential area. My husband and I bought our home in 2020 in hopes that this would be our forever home for us and our 3 children. We love our house and most of all love the lot we are on. Much of that has to do with the openness and the farmed field that we get to look out to each and every day. I have attached pictures of the view from all of the windows on the south side of our home including the views from our 2nd story bedroom windows. We will be looking out and down on a field of solar panels from our bedroom that no vegetation will hide. There are also pictures from the views out my front window, the view from our four seasons room, and from my back and front yard. The solar panels will be extremely close to our property line and will significantly be seen from inside and outside of our home and coming down our road that we live on. We are heartbroken that this is a possibility of being our new view. We would have never, and would never voluntarily live next to a solar energy facility. Please consider all our concerns below along with the attachments as documentation to back them up.

1. Appearance and property value:

-We absolutely love what we get to look at every day. We also loved all the wildlife especially the deer we would get very frequently coming up to the side of our house which has no longer happened since the woods were removed from the field. A lot of the residents will have the solar facility seen from the back of the yard which would have been covered by woods but it was all completely removed. From our house specifically, it will come up to the side of our home and through the front of our lot up to our road. This will drastically impact us and the neighbor across the street from us.

-There are mixed reviews on whether or not solar facilities impact property value. I know I would never look at home that was next to one along with majority of my neighbors. So, the population of people looking at home next to one along with purchasing one has to be greatly decreased. Therefore, saleability is greatly affected and the solar facility is

most likely used as leverage to decrease an offer from the smaller percentage who would be willing to buy.

- Lawrence Berkely National Laboratory has stated that based on research in six different states, homes within a half mile of a solar facility decreases by about 1.5% and we are within 150 feet of it.

2. Fire Hazard/Aircraft flight path (Please see attached document):

- We are located in unincorporated Elgin, and we are all on well water. There is a concern on what this project would do to our water but there are also worries of what would happen if a solar fire occurred. Lily lake had a solar fire in 2021. In 2023 Farnington, IL also had one that started in an inverter panel and spread. Just this past February, there was one in Peoria, IL. This field and the location of these panels are surrounded by residents' homes. Pingree Grove fire department is usually who responds to calls in our area. Would like to hear their feedback on how they would handle a situation of a fire caused by the solar facility in the field and if it's reasonable to put it here due to surrounding homes at risk.

3. Health/Noise

- There are not any definitive answers on the health effects of living next to a solar facility. They do give off electromagnetic fields from sun to sun down every single day and I have three little ones to worry about that will be living within 150 feet of this. According to multiple sites including gosolarfloridastate.org and the World Health Organization according to a few sites that a safe distance to live next to a solar farm is .12 miles (656 feet) away to small scale and .3 miles (1640 feet) from large scale. WHO recommends solar farms be built at least 1.2 miles away from resident homes to be cautious. The Proposal shows 150 ft from our property line which makes it about 180 feet from our windows. And where there are trees in our backyard, he is planning to place the panels only 55 feet from them according to his screening plan and geometric site plan. The Panels are sealed but there are possibilities of damage that can lead to leakage of toxic chemicals. We are within throwing distance of the planned facility and that is a huge concern of ours. We also had to deal with about 10 acres of woods being cut down that has affected the wildlife here on our side of the field and the disturbance was tremendous. Trucks coming through, the constant cutting and piling of trees went on for months. And now another project that will take months long and entail maintenance which I do not believe belongs within residential neighborhoods. We are not an industrial area, we are a peaceful, and beautiful area, surrounded by homes and residents who love our neighborhood.

4. Bills regarding Solar farms

- There are numerous people especially Illinois senators fighting to help control where solar facilities are placed. Senator Sue Rezin, Jill Tracy, along with others are trying to conform it be more localized legislation to avoid these situations for homeowners and to push back the setback distances from existing residents. In hopes that this happens it would be to late for our community if this project gets passed.

Kane County has rejected other proposed solar facilities in the past years. One in Plato Township was rejected in 2019 due to being too close to neighbors. A solar farm in Gilberts was also rejected. Winnebago rejected one outside of Rockford in 2023 along with New Lenox Township who fought for the residents that showed their concerns, and us residents here are willing to try to stop this from happening.

Please we ask you to consider our homes, our lifestyles, and our community here. In Article 2 Purpose on 25-2-1: stated "The Kane County zoning ordinance is adopted for the purpose of promoting the public health, safety, morals, comfort, and general welfare, conserving the values of property throughout the county; and reducing or avoiding congestion in the public street and highways". We truly believe this will change comfort, general welfare, values of property, possibly public health, and the overall beauty of the surrounding neighborhoods that are involved in this. Please consider if this solar energy facility was being placed on the side of your home?

Please consider voting against what is to you a project but to us an unwelcomed change to our everyday lives and neighborhood. At the least, please re-consider the proposed plans and not have it come all the way to the side of our home and up to the road we and my neighbors live on. Tim has stated in his landscape and screening plans that there are existing trees and that he will not need to cover those parts of the solar facility. One of those lines of trees he refers to is in my yard and is small and not that much coverage. For about 5 ½ to 6 months out of the year that tree line has no leaves and is bare and we would see right through it with the solar facility being visible and only 55 feet away from it. According to the Kane County ordinance #5007 on page 25, "vegetative screen shall be provided for any part of the solar energy facility that is visible to non-participating residents. We wanted this to be our forever home for our kids and this may change that. Please, please, help us keep what we love so much!!

Thank you for your time!

Sincerely,

Jacqueline and Brandon Thompson along with the residents who signed below

RESIDENTS NAME	ADDRESS	SIGNATURE/DATE
<i>[Signature]</i>	11	
Jacqueline Thompson	12N271 Jackson Dr.	<i>[Signature]</i> 7/9/25
Brandon W.P. GWT	12N268 Jackson Dr.	<i>[Signature]</i> 7/9/25

NAME

ADDRESS

SIGNATURE

Paul Carley	12 N 346 Rackstr Dr. Elgin 60124	7/9/2025
LORI WHALEN	37W435 LINDA ELGIN 60124	7/9/25 Lori K. Whalen
Paul OLSEN	12N260 CHARLOTTE	Paul OL
Debby Kaufman	12N261 Charlotte Ct Elgin 60124	7/9/25 Debby Kaufman
Gary Kaufman	12N261 Charlotte Ct Elgin 60124	7/9/25 Gary Kaufman
Norma Laurie	37W309 Linda Ln. Elgin IL 60124	Norma Laurie
JOHN SORENSON	12N300 TINA TR	John Soren
Jerry Martinez	12N201 Tina Trail Elgin, IL 60124	Jerry Martinez

Mary Martinez	12N201 Tina TR. Elgin, IL 60124	Mary Martinez
---------------	------------------------------------	---------------

Griselda del Rio

BOB DEATON

12N355 Tina Tr
Elgin IL 6012437W304
LINDA LN 60124

Griselda del Rio





Angel E Rodriguez	12N385 JACKSON DR	ELGIN ILL. 60124
Austin Thompson <i>Austin Thompson</i>	12W202 Westview St.	Elgin, IL 60124
Jerry Snopce Calvin Taylor	11N958 Almora Terr, Elgin IL 60124	JS CT
Dan Webster Elgin 60124 11N907 Almora Tr. →		Dan Webster
Roy A Engstrom	11N918 Almora Terrace	Elgin IL 60124 <i>Roy A Engstrom</i>
Pat Bartosz Young	37W166 Brookside Drive	Pat Young Elgin IL 60124
Joe McDermott	37W137 Brookside Drive	<i>Joe McDermott</i>

Catherine Houder	11 N. 999 Almora Terrance	Elgin IL 60124
------------------	------------------------------	-------------------

Michelle Schmidt

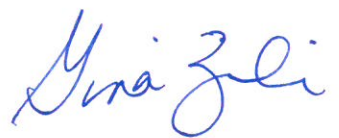
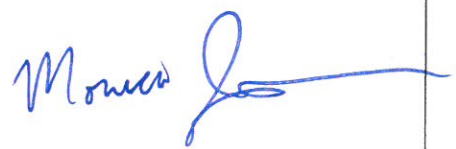
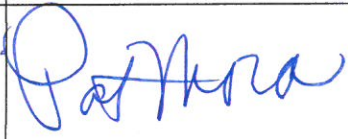
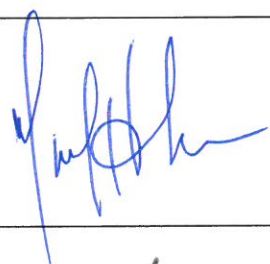
12 N376 Jackson Dr
Elgin, IL 60124

Michelle
Schmidt

David Schmidt	12N376 JACKSON DR. ELGIN, IL 60124	
Gina Ziccardi	37W390 Linda Ln Elgin, IL 60124	
Monica Jackson	11N936 Almore Ter Elgin IL 60124	
Pat MORA	299S Marshfield DR. ELGIN, IL 60124	
MARK GREEN	2960 MARSHFIELD DR. Elgin IL 60124	
BON AGUILAR	2974 MARSHFIELD CT ELGIN, IL 60124	
Rodney McWhorter	12N225 Tine Trail Elgin IL 60124	
Bonnie Schuring AL Schuring	11N916 Hill Top Rd Elgin, IL 60124	

Christina Conrardy 2889 Weld Rd
Patrick Conrardy Elgin, IL 60124

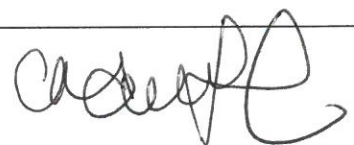

Our House
12221
Jackson Dr.

a. Aerial View



Homes
are surrounding
the solar
facility

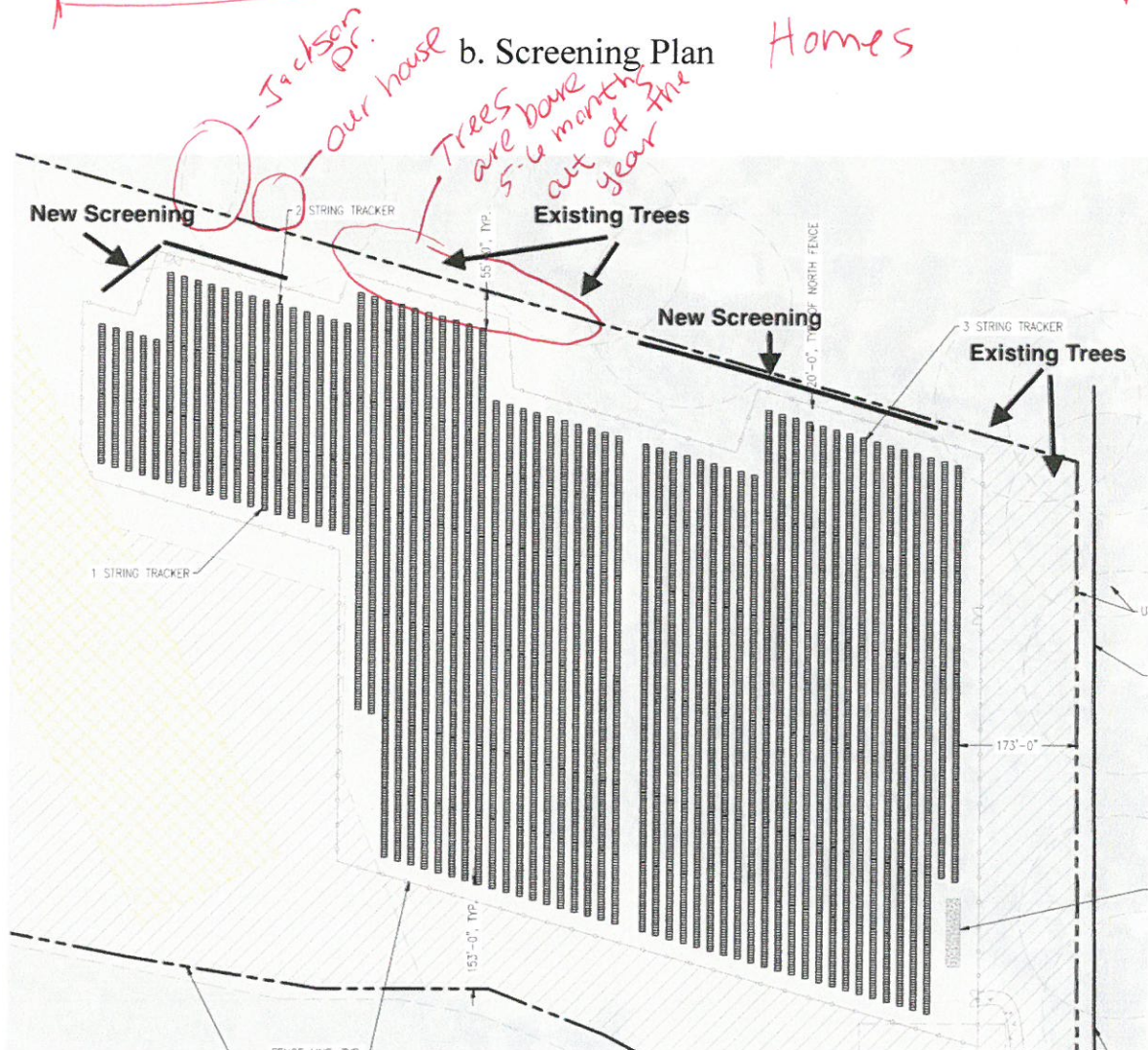

18. Landscape & Screening Plan

I. Title Bar

Document Name: Landscape & Screening Plan
Project Name: TNT Howard LLC
Zoning Petition No: TBD
Site Location: Brookside Drive & Almora Terrace, Elgin, IL 60124
Parcel Number: 06-08-401-013
Solar Company: TNT Howard LLC, 5 Middlebury Rd, Barrington, IL 60010
Contact: Timothy R Meyer 312-953-5618
Prepared By: Timothy R. Meyer Engineer EIT
Prepared Date: May 16, 2025

II. Plan Information

Property location: Parcel# 06-08-401-013,
Site location is in S8-T41N-R8E, Elgin Twp, Kane Co., IL
Legal description below.
Residential zoning to the N & E, Farm zoning to the W & S.

Existing/Future Use Current use is F District – Farming.
Future use 5MW (AC) solar PV array on up to 40 acres.

Setbacks/restrictions: No buildings or residences on subject property,
Setbacks shown for homes in range (150') and borders (50').
DOT gave approval to use Brookside Dr. Tk wts are below limit.
Panel height will be less than 20'.
No substations are on site. Lines will attach to ComEd in SE corner.
All power & communication lines shall be installed per AIMA.

Attachments:

- a. Aerial view
- b. Screening plan
- c. Trees, shrubs, etc. sample
- d. Pollinators and grasses for ground cover
- e. Fencing

THIS will
be seen
from 14
different
windows
in our home.

3 of those
are from the
2nd story in
our bedroom.

At 12W271 Jackson Dr.

- If nothing else please
re-consider the proposed
setback limits. Too close
to our homes.



SCALE: 1" = 100'



1. LAYOUT AND FINAL EMBEEDMENT DEPTH SUBJECT TO CHANGE UPON RECEIPT OF CIVIL AND GEOTECHNICAL REPORTS

Please re-consider setbacks and not coming to the side of our house at 12N271 Jackson Dr.

Holmes will be in there
- A road will be for this
backwards facility

TNT HOWARD LLC
SOLAR ELECTRIC SYSTEM

NOT FOR
CONSTRUCTION

Trina

THE PROGRAM IS DESIGNED TO PROVIDE THE LATEST INFORMATION TO RESEARCHERS AND TO PROVIDE A MEANS FOR THE DISSEMINATION OF RESEARCH RESULTS TO THE GENERAL PUBLIC.

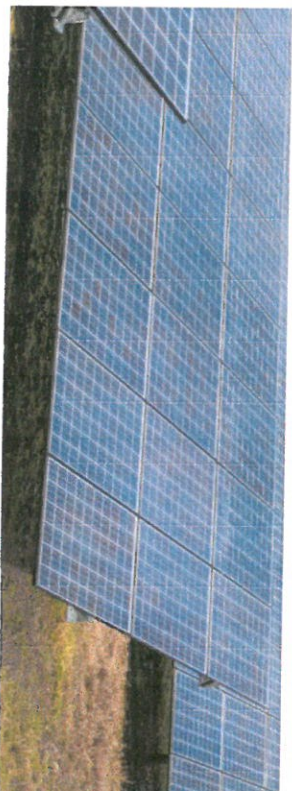

Solar farms are becoming more and more common as we shift towards renewable energy sources. Many people welcome solar farms to their communities as an environmentally-friendly source of energy. However, some people worry about the potential downsides of having a large solar energy plant as a neighbor.

What is a Safe Distance to Live from a Solar Farm

So what is a safe distance to live from a solar farm? According to the World Health Organization, there is no significant research that proves living near a solar farm is harmful due to EMF exposure. Still, in general, solar farms are required to be built at least 3 km (1.86 miles) from residential areas. It's a good idea to know if the operation is a large scale farm or a small scale. Typically, it's recommended to live at least 500m (0.3 miles, 1640 feet) from large-scale farms and 200 km (0.12 miles, 656 feet) from small scale.

This article will explore the factors to consider when evaluating the safest distance.

Potential Risks When Living Near a Solar Farm Noise Concerns

One of the top concerns people have about living near solar panels is noise. Large solar farms contain thousands of solar panels, inverters that convert solar energy to usable electricity and transformers. These components do make noise, especially the inverters. However,

Get an instant ballpark solar estimate using satellite!

GET ESTIMATE!

AMENDMENT TO THE KANE COUNTY CODE, CHAPTER 25, ZONING
ORDINANCE REGARDING WIND ENERGY CONVERSION SYSTEMS
AND COMMERCIAL SOLAR ENERGY FACILITIES
IN THE UNINCORPORATED AREAS OF KANE COUNTY
Petition #5007

Page 25:

1. Vegetative Screening: A vegetative screen shall be provided for any part of the Commercial Solar Energy Facility that is visible to Non-participating Residence(s).



View from Pine Tree Subdivision - NE



[Search](#)[Cart](#)[Log In](#)[Donate](#)[About IFM](#)[Functional Medicine](#)[Health Topics](#)[Find a Practitioner](#)[Health Professionals:](#)[Join Us](#)[Education](#)[Certification](#)[Toxins & Detoxification](#)

Ifm.org

The Institute for
Functional medicine

EMFs: Health Impacts and Reducing Exposures

PRACTITIONER | Reading Time: 4 minutes | Written on: September 13, 2024

- World Health Organization also recommends to limit exposure to be cautious

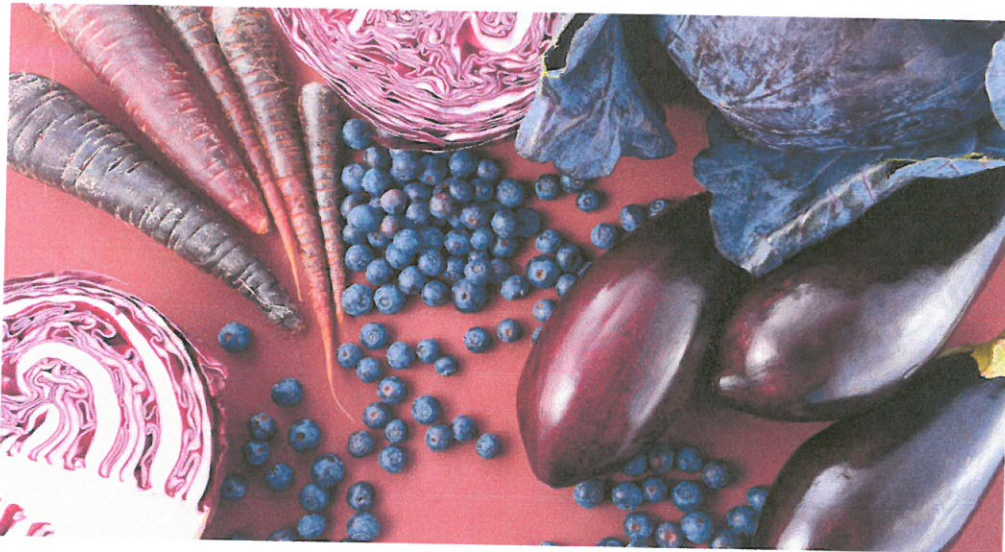

- Solar Facility will emit EMFs continuously from sun up to sun down every day

Electromagnetic fields (EMFs) are invisible areas of radiation that are created both naturally (e.g., earth's magnetic field and sunlight) and by human invention (e.g., cell phones and power lines).¹ Advancing technologies and higher electricity usage have increased daily exposure to artificial EMF sources, and some research studies, from animal models to human-based observational studies, suggest potential negative health

impacts associated with long-term EMF exposures.²⁻⁶ What are common sources of EMFs, the potential health implications, and the functional medicine approaches to address a patient's total environmental toxicant load?

EMF Pollution: Common Exposure Sources & Potential Health Impacts

Both electric and magnetic fields are produced by electricity and grow in strength as voltages and currents increase. Of interesting note, it has been reported that electric fields are produced whether a device is turned on or not and are weakened by walls and other objects while magnetic fields are only produced when current is flowing and can pass through buildings, living things, and other materials but decrease in strength farther from the source.¹ While there are many EMF sources to consider, some common exposures may include:^{1,7}

- Higher frequency EMFs such as ultraviolet radiation, x-rays, and gamma rays.
- Low and mid-frequency EMFs from electric power lines and appliances, radio waves, microwaves, and visible light.
- Extremely low frequency and radiofrequency EMFs from computers, wireless networks, cell phones, cell phone towers, and Bluetooth devices.

This list is only a sample of potential EMF exposure sources for the general public. EMF exposures, especially in the extremely low frequency range, are ubiquitous in the modern digital world, and research continues to detail the health impacts of these chronic and cumulative EMF exposures. Some official agencies point to limited and conflicting EMF research on health effects and maintain that at current levels, low and extremely low frequency EMF exposures are not associated with increased health risks such as cancer.^{1,7,8} However, some agencies and studies have raised concerns about the current established EMF exposure limits due to co-exposures to other potential carcinogenic agents in the environment, an individual's potential sensitivity to EMFs and radiation, and the cumulative impact of widespread EMF exposures.^{1,9-11}

Recent observational studies and meta-analyses of human studies have suggested that exposure to various levels of EMFs may result in clinical patterns of toxic health effects among some populations, such as endocrine disruption,⁴ mental health disturbances,¹² cardiovascular abnormalities,¹³ increased oxidative stress,¹² and increased Alzheimer's disease⁶ and tumor risk.⁵ As an example, a 2023 observational study examined the effects of electromagnetic radiation at the common frequencies for Wi-Fi data transmission and 4G mobile networks on heart rate variability among younger healthy adults (n=30).¹³ During the study, EMF exposure was applied for five minutes to the chest area of the

participants, and results indicated a shift in cardiac autonomic regulation toward sympathetic overactivity and parasympathetic underactivity during exposure. Authors concluded that these abnormal shifts during EMF exposure may be associated with a higher risk of cardiovascular complications among this population.¹³

Clinical Applications & the Functional Medicine Approach

With all environmental toxicants and pollutants that may negatively impact health, the first steps of a functional medicine approach are to identify and evaluate patterns of potential toxic exposures and to ultimately reduce levels of those exposures. Specific to artificial EMF

Cookiebot
by Usercentrics

Please select your cookie preferences

Subject to your preferences, we and our partners use cookies and similar tracking technologies to help the website function, enhance your browsing experience, serve personalized content and advertisements, view and retain your interactions on the site, and analyze our traffic. Review our Privacy Policy [here](#) for details.

After addressing levels of exposure, assessment of a patient's total toxic load and supporting the body's detoxification and elimination pathways through lifestyle modifications as well as nutritional support are essential pieces of a personalized therapeutic treatment in functional medicine.

Customize >

Optimizing a patient's nutritional status, ensuring adequate fiber and water intake, eating more phytonutrient-dense and diverse foods, and supporting liver function through targeted, nutrient-dense diets are all dietary treatment approaches within the functional medicine model that may help to improve the elimination of toxic compounds and to alleviate toxic burden. And while the research continues to develop, preliminary results from animal model and human-based research suggest that nutrients such as vitamin C, vitamin E, omega-3 fatty acids, and various plants and herbs may mitigate some of the negative health impacts that have been suggested for chronic EMF exposure such as increased oxidative stress and endocrine disruptions.¹⁴⁻¹⁸

At IFM's Environmental Health Advanced Practice Module (APM), learn more about EMFs, how your patients' physical environment and toxicant exposure levels may impact their health outcomes, and what functional medicine tools and lifestyle-based approaches may benefit their wellness path.

Learn more about
Biotransformation
Pathways & Toxic Exposure

Explore